

# FOR LEASE South I-355 Medical Office Space

15900 West 127th Street | Lemont, Illinois



**VIRTUAL  
TOURS  
NOW  
AVAILABLE!!**  
 See Below

## Property Highlights

- Lemont Professional Center addresses the strong population growth and need for outpatient services and physicians for the residents of the south I-355 corridor communities
- Immediate access to interchange at 127th Street and the I-355 extension
- Beautiful campus setting
- Fully improved medical and office suites available
- Over 200 parking spaces in lighted lot
- Current medical services in the building include: walk-in care center, imaging, ophthalmology, internal medicine, and dental care
- Professionally managed by HSA PrimeCare

Suite	Area	Contiguous	Existing Condition
121A	2,446 SF	5,888 SF	Second Generation Medical Office
121B	3,442 SF		Second Generation MRI
220	1,150 SF	9,403 SF	Shell Space
230	1,416 SF		Second Generation Physical Therapy
240	1,909 SF		Second Generation Medical Office
261	1,840 SF		
241	3,088 SF		Ready to Occupy Spec Office

### Virtual Tours by Suite

121

230

240

241

## Contact

Robert Titzer  
 p 312.458.4468  
[rtitzer@hsacommercial.com](mailto:rtitzer@hsacommercial.com)

# FOR LEASE South I-355 Medical Office Space

15900 West 127th Street | Lemont, Illinois

## Floor Plan - 1st Floor

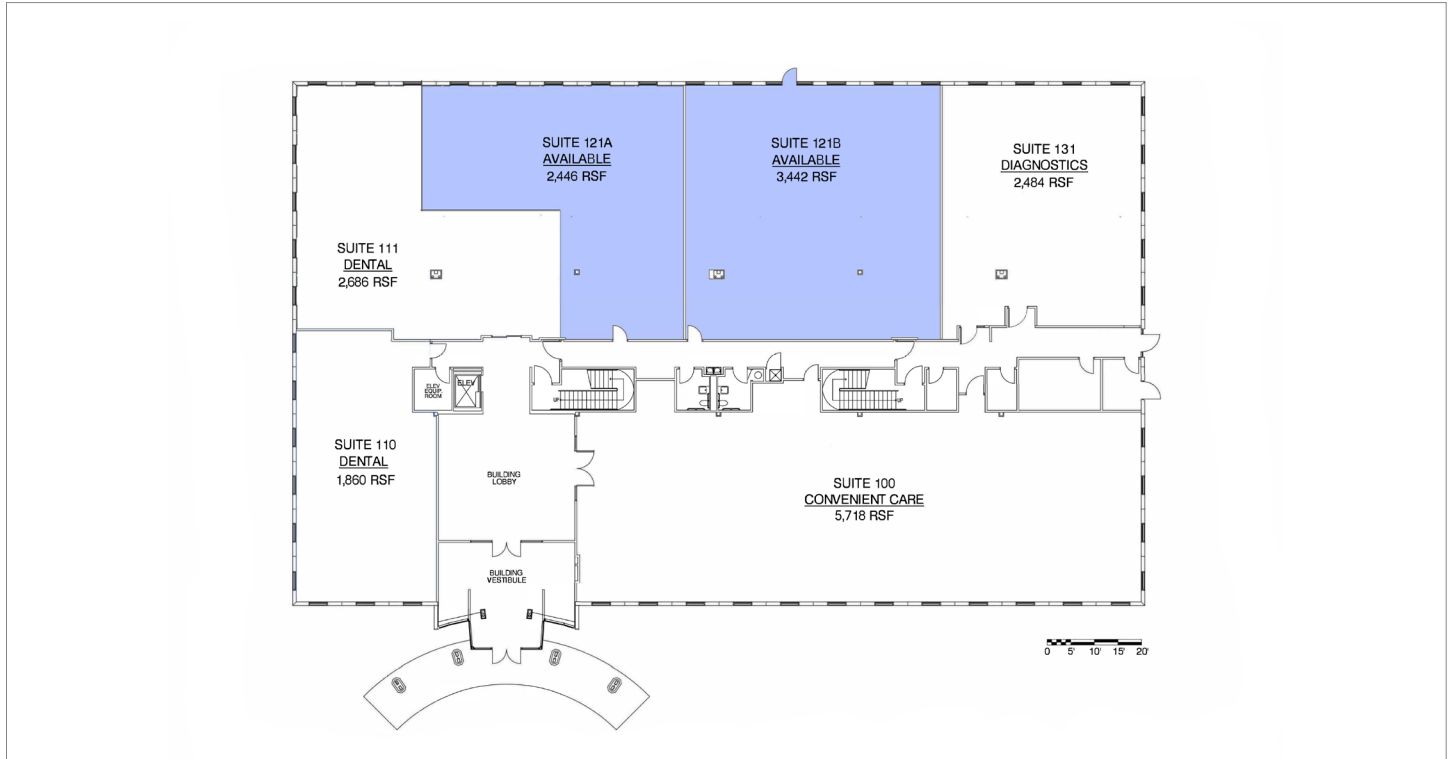

## Floor Plan - 2nd Floor

